

Location Plan
1:10,000@A3

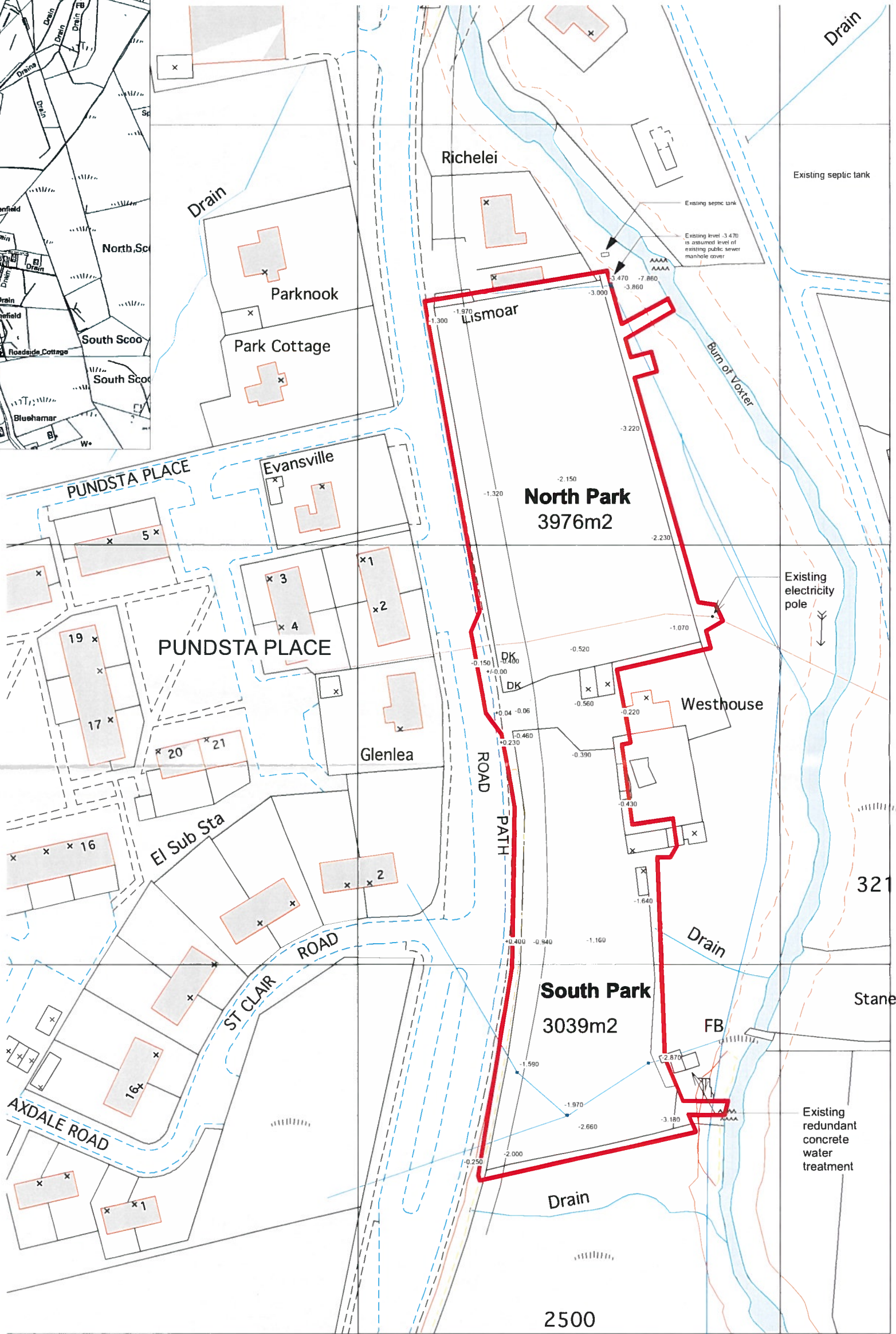

Site Plan
1:1000@A3

B / 10.11.14 / Existing ground levels amended
A / 5.9.14 / Existing ground levels added
REV / DATE / REVISION

PLANNING (PPP)

Project	Proposed Housing sites development North & South Sites near West House, Pundsta, Cuningsburgh, Shetland		
Drawing	Location Plan & Site Plan - Existing		
Scale	As Shown	Nov14	RGA 918(PPP)01B
Richard Gibson Architects			
Ltd Co. 72a Commercial Street Lerwick Shetland ZE1 0DL			
t: 01595 695000 e: mail@rg-architects.com www.rg-architects.com			

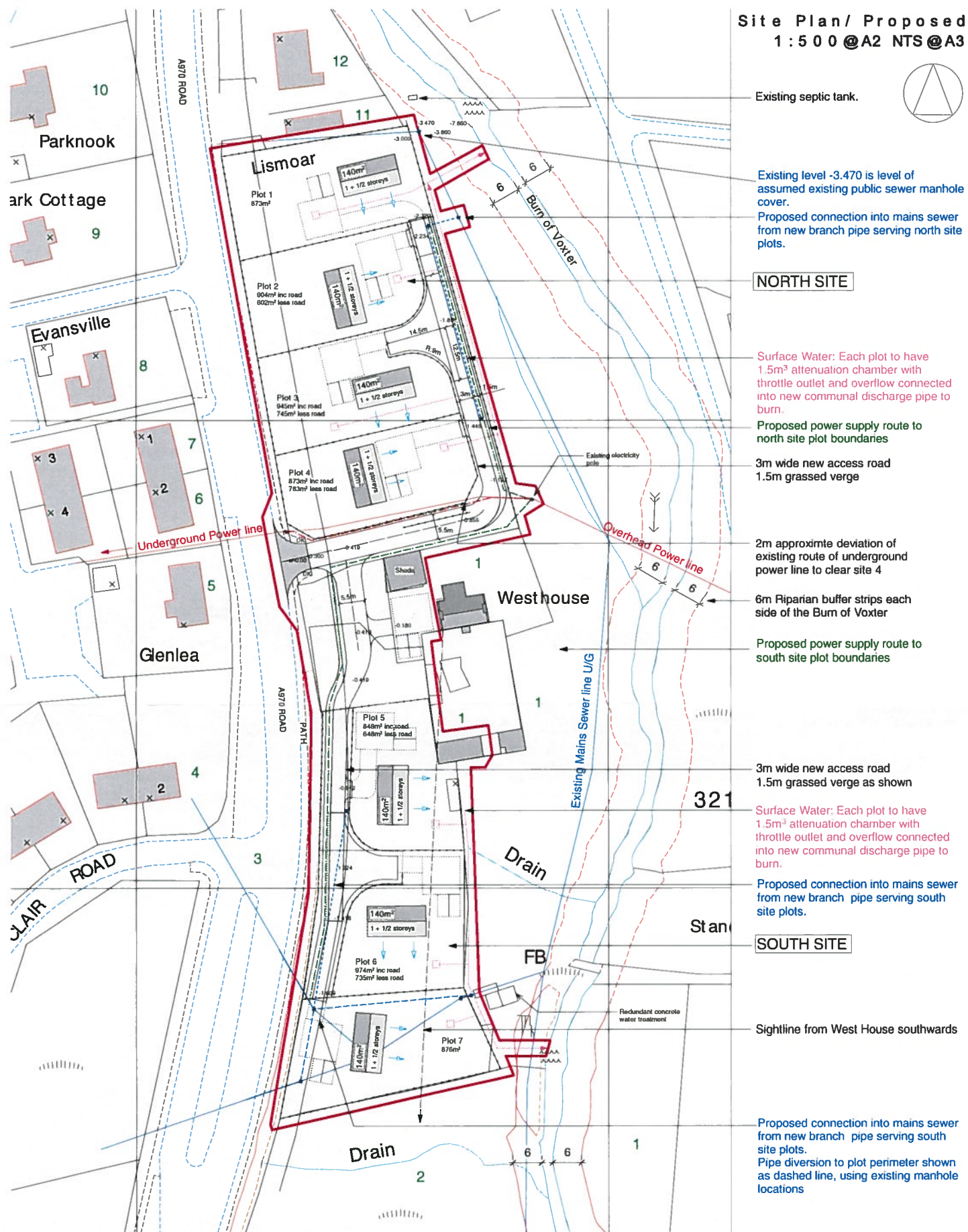

Neighbour Notification Information. Please note that the following is understood to be accurate.

- 1 - (Applicant) Virginia Johnston, Columbia Cottage, 39 Broomie Knowe, Leamside, Midlothian, EH16 1LN
2 - Douglas Halcrow, Town, Cummingsburgh, Shetland, ZE2 9HB
3 - SAC, Town Hall, Lerwick, Shetland, ZE1 9SU
4 - 2 St. Clair Road, Cummingsburgh, Shetland, ZE2 9HD
5 - Glenlea, Cummingsburgh, Shetland, ZE2 9HB
6 - 2 Pundist Place, Cummingsburgh, Shetland, ZE2 9HQ
7 - 1 Pundist Place, Cummingsburgh, Shetland, ZE2 9HQ
8 - Evansville, Cummingsburgh, Shetland, ZE2 9HB
9 - Park Cottage, Cummingsburgh, Shetland, ZE2 9HB
10 - Park Nook, Cummingsburgh, Shetland, ZE2 9HB
11 - Ritchie, Cummingsburgh, ZE2 9HB
12 - Ritchie, Cummingsburgh, ZE2 9HB

Note:

- This drawing is indicative of proposed roads, house locations and associated underground services. Detail consideration to be carried out at Full Planning Stage when reached.
- Proposed levels based on new datum of 0.00 from at proposed access point on existing pavement

B / 10.11.14 / Existing ground levels amended
A / 5.0.14 / For Planning - Indicative proposed road levels + general note added; Rainwater attenuation chambers relocated to be min 5m from all boundaries and houses
REV / DATE / REVISION

PLANNING (PPP)

Project Proposed Housing site development,
North & South Sites near West House, Pundist
Cummingsburgh, Shetland

Drawing Site Plan / Option 5
Scale 1:500 Nov 14

RGA 918(PFP)02A

Richard Gibson Architects

Ltd Co. 72a Commercial Street Lerwick Shetland ZE1 0DU

T: 01593 630295 F: 01593 630111 E: r.gibson@rga-architects.com W: www.rga-architects.com

Site Plan/ Proposed 1:500 @ A2 NTS @ A3



Existing septic tank.

Existing level -3.470 is level of assumed existing public sewer manhole cover.
Proposed connection into mains sewer from new branch pipe serving north site plots.

NORTH SITE

Surface Water: Each plot to have 1.5m³ attenuation chamber with throttle outlet and overflow connected into new communal discharge pipe to burn.

Proposed power supply route to north site plot boundaries

3m wide new access road
1.5m grassed verge

2m approximate deviation of existing route of underground power line to clear site 4

6m Riparian buffer strips each side of the Burn of Vortex

Proposed power supply route to south site plot boundaries

3m wide new access road
1.5m grassed verge as shown

Surface Water: Each plot to have 1.5m³ attenuation chamber with throttle outlet and overflow connected into new communal discharge pipe to burn.

Proposed connection into mains sewer from new branch pipe serving south site plots.

SOUTH SITE

Sightline from West House southwards

Proposed connection into mains sewer from new branch pipe serving south site plots.
Pipe diversion to plot perimeter shown as dashed line, using existing manhole locations

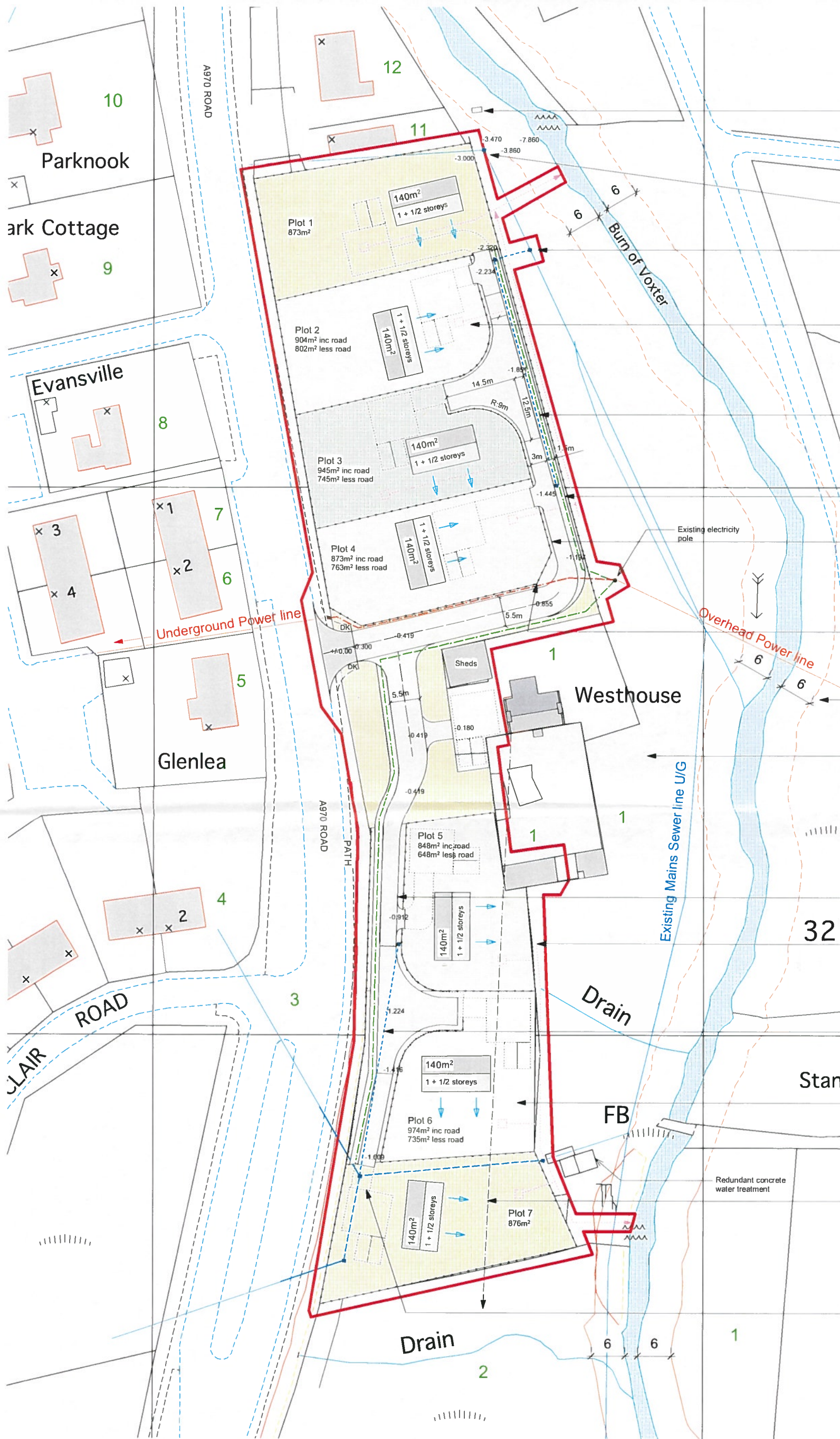

Neighbour Notification information: Please note that the following is understood to be accurate, however it is up to the notifying body to verify this for their own satisfaction.
1 - (Applicant) Virginia Johnston, Columbia Cottage, 38 Broomie Knowe, Lasswade, Midlothian, EH18 1LN
2 - Douglas Halcrow, Tow, Cunningburgh, Shetland, ZE2 9HB
3 - SIC, Town Hall, Lerwick, Shetland, ZE1 9SU
4 - 2 St. Clair Road, Cunningburgh, Shetland, ZE2 9HD
5 - Glenlea, Cunningburgh, Shetland, ZE2 9HB
6 - 2 Pundsta Place, Cunningburgh, Shetland, ZE2 9HQ
7 - 1 Pundsta Place, Cunningburgh, Shetland, ZE2 9HQ
8 - Evansville, Cunningburgh, Shetland, ZE2 9HB
9 - Park Cottage, Cunningburgh, Shetland, ZE2 9HB
10 - Park Nook, Cunningburgh, Shetland ZE2 9HB
11 - Richelei, Cunningburgh, ZE2 9HB
12 - Richelei, Cunningburgh, ZE2 9HB

Note:
-This drawing is indicative of proposed roads, house locations and associated underground services. Detail consideration to be carried out at Full Planning Stage when reached.
-Proposed levels based on new datum of 0.00 from at proposed access point on existing pavement

B / 10.11.14 / Existing ground levels amended
A / 5.9.14 / For Planning - Indicative proposed road levels + general note added; Rainwater attenuation chambers relocated to be min 5m from all boundaries and houses
REV / DATE / REVISION

PLANNING (PPP)

Project **Proposed Housing site development, North & South Sites near West House, Pundsta Cunningburgh, Shetland**

Drawing Site Plan / Option 5
Scale 1:500 Nov 14

RG 918(PPP)02B

Richard Gibson Architects

Ltd Co. 72a Commercial Street Lerwick Shetland ZE1 0DL
t: 01505 855488 f: 01505 894117 e: mail@rg-architects.com www.rg-architects.com

Proposed North Access Road:
Section AA (centre line)

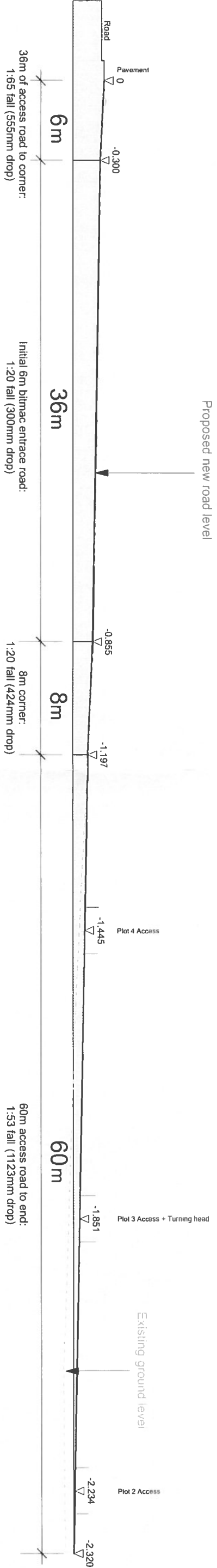

Proposed South Access Road:
Section BB (centre line)

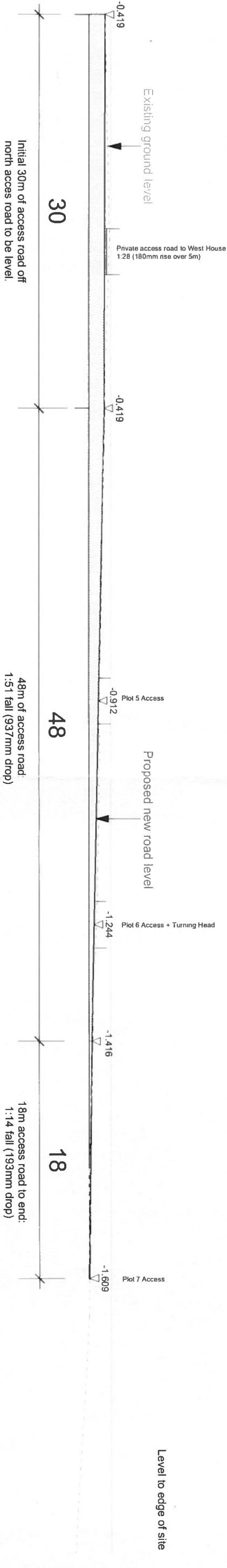

Indicative Road Plan

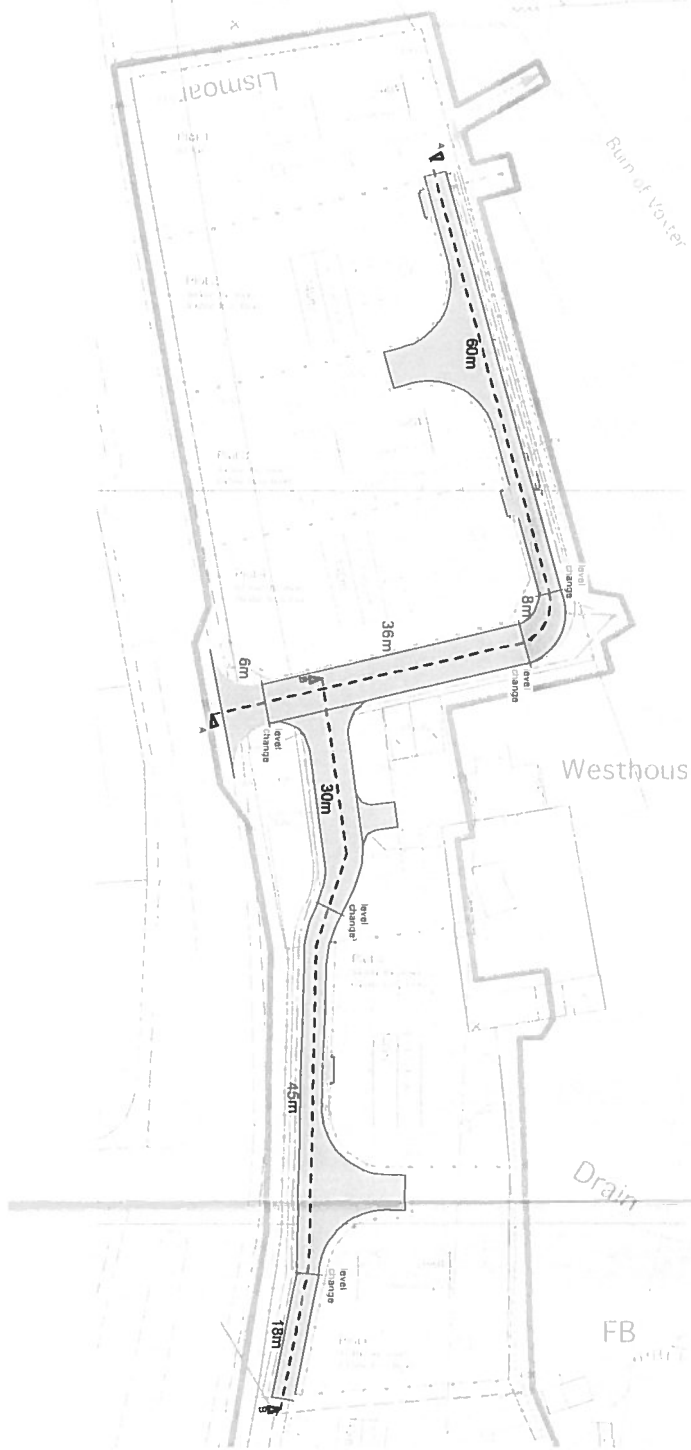

Note:
This drawing is indicative of proposed road levels and gradients.
Detail design of the road, including vertical curves has not been carried out at this stage and should be considered at Full Planning Stage when reached.

REV / DATE / REVISION

Project Proposed Housing site development,
North & South Sites near West House, Pundsta
Cunningsburgh, Shetland
Drawing Proposed north/south access road section
Scale NTS
Sept 14
RGA 916(PPP)03

PLANNING (PPP)

Richard Gibson Architects
Ltd Co. 72a Commercial Street, Lerwick, Shetland ZE1 6BL
t: 01595 695666 e: mail@rg-architects.com www.rg-architects.com